

# COMMONGROUNDS WORKPLACE

DOWNTOWN LOS ANGELES  
915 WILSHIRE BLVD., LOS ANGELES, CA 90017  
**45,978 SF**





## Downtown Los Angeles:

The 22-story building presents unobstructed views of the city, and a 7th floor roof deck that provides CommonGrounds downtown LA a coastal, fresh feel. It is an easily accessible and walkable location supplied with ample, lavish amenities. Enjoy short distances to downtown happenings like the Miracle Mile shopping district and array of local restaurants and cuisines.

---

### Building Features:

- Renovated lobby & boutique Class A feel
- 7th floor roof deck and indoor/outdoor patio
- Elegant design and unobstructed city views

---

### Professional:

- Reception & communal areas
- Fully furnished offices with 48" & 60" electronic sit-stand desks and chairs
- Video ready meeting and conference rooms











---

### WorkLife:

- Five-minute walk to 7th St/Metro Center Station
- Onsite restaurant and bar
- Great selection of upscale restaurants, shopping and entertainment nearby



## Office Membership Amenities:

-  Fully furnished private offices with electronic 48" & 60" sit stand desks, ergonomic office chairs & storage
-  Salto fob key to access secured workplace areas and office
-  Dual fiber secure, high speed Wi-Fi and ethernet
-  Secure IT server infrastructure, private rack space available
-  Shared kitchen area with pantry, and assorted complimentary beverages
-  Complimentary in-house printing services
-  Hand-delivered mail and package service, plus business address
-  Accessible parking locations
-  Flexible term options from Month-to-Month to 3-year agreements
-  All-inclusive membership rates include taxes, fees and utilities
-  Video-ready meeting areas and conference rooms



## CG+ APP

- Subscribe to a membership plan
- Manage your billing and invoicing
- Make edits to your membership
- Book a conference room
- Message your team
- Explore all CommonGrounds locations
- Register for an upcoming event, speaker or education





## Why CG:

At CommonGrounds, we are leading the evolution of the workplace away from long-term and stagnant to dynamic and sophisticated. We have designed human-centric workplaces in thriving markets with the latest technologies, services and furnishings; while delivering more frictionless environments to drive the twenty-first-century workforce. Keep your culture, lose the confines.

Where you work matters. That's why we believe that work and life need to be in sync for individuals and teams to perform at their best. We strive to design environments that promote productivity and harmony.

## We offer Workplace-as-a-Service through:

- Dedicated onsite workplace team to curate relationships through an Activated Ecosystem™
- Hackable Environments™ featuring demountable TECNO wall solutions to meet the ever-shifting spatial demands of our clients
- Functional & frictionless environments
- Workspace designs for maximum productivity through varying Work Typologies™
- Hybrid Mobility™ model to promote collaboration through flexible workspaces
- Salto fob key security
- Dual provider gigabyte fiber lines
- Fortinet Firewall system to ensure maximum network security
- Cisco Meraki Switch cloud network management
- Airmidia AV Technology & Crestron hardware
- Our proprietary CG+ mobile app to streamline worklife
- Headquarters-as-a-Service to help create a dynamic branded workplace for your business



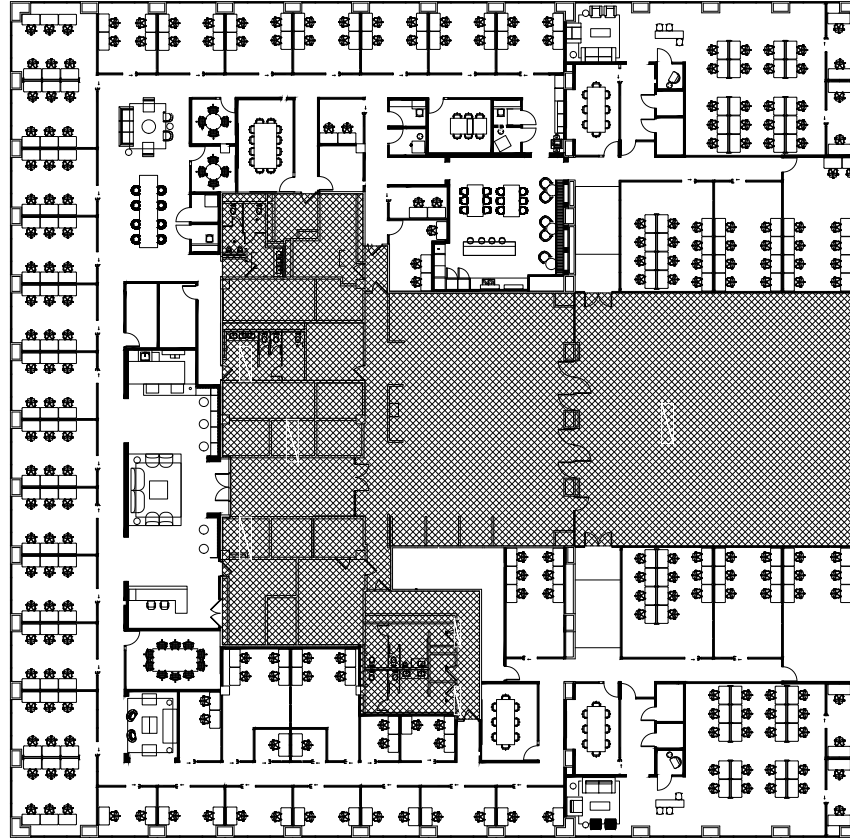

- Roof Deck patio
- Private desks (8)
- Private phone booths (7)
- Conference rooms (8)
- Communal seating
- Barista and pantry with complimentary beverages
- Reception & mail room
- Print & scan station
- Restrooms

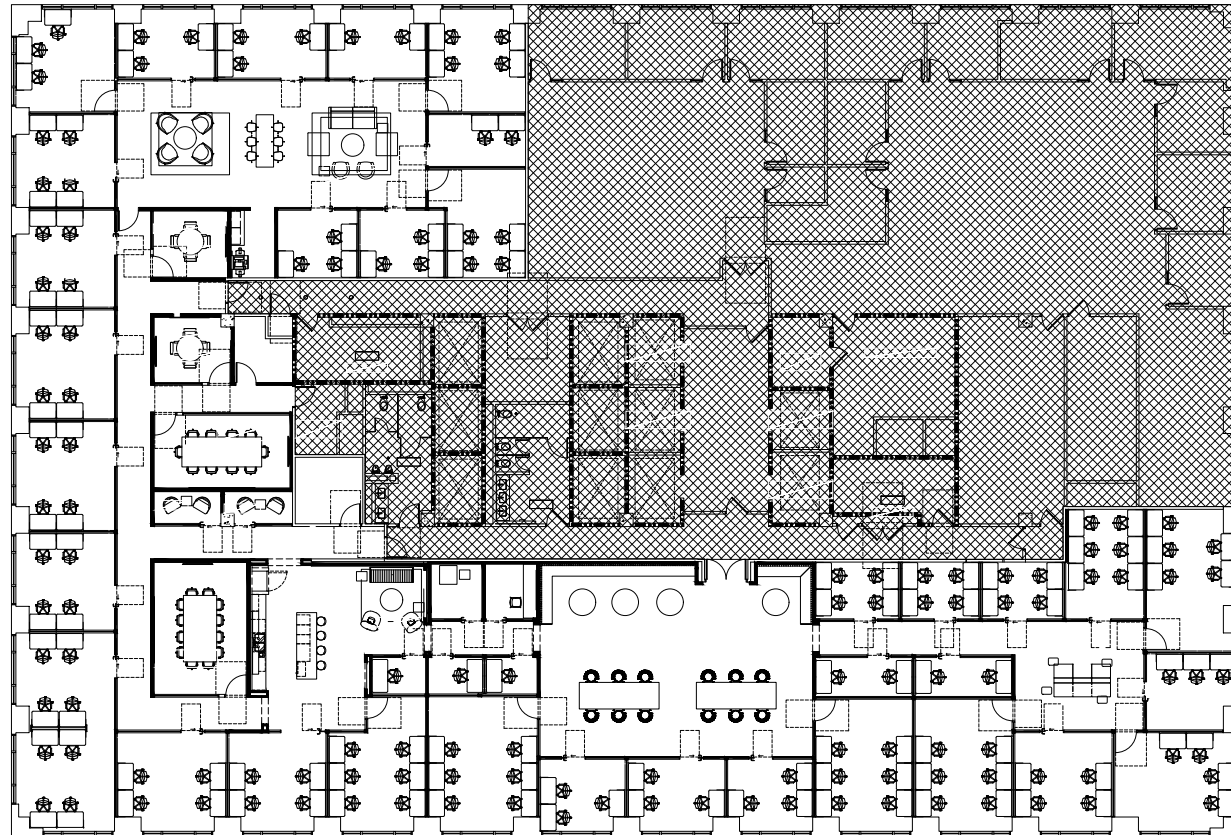

- Private desks (12)
- Private phone booths (4)
- Conference rooms (4)
- Communal seating
- Shared kitchen & pantry
- Print & scan station
- Restrooms

915 Wilshire Blvd., Los Angeles, CA 90017







## ENTERPRISE

- 🕒 24/7 full access to entire workplace
- 🏠 Proprietary wall system allows for almost unlimited configurations
- 🏢 Furnished workspace with access to in-house design team for alternate layouts and fixtures
- 📍 Perfect for a company looking for a downtown LA location



## About Downtown Los Angeles:

-  Walkable to shops, restaurants and downtown area
-  Five minutes from Dodger Stadium
-  A few blocks from public parks (Maguire Gardens & Pershing Sq.)
-  Seventh floor roof deck patio with city views

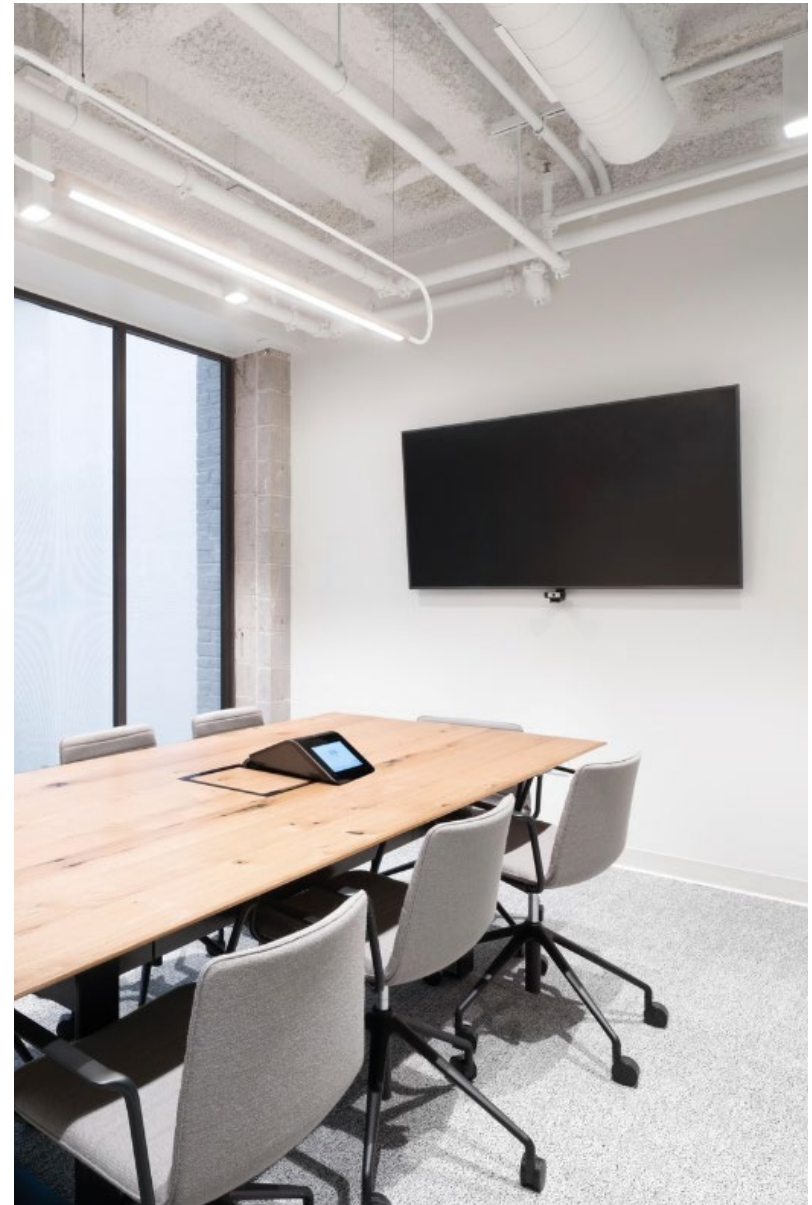



## Map, parking, transit:

- Two blocks from 7th St/Metro Center Station
- Underground parking
- Close proximity to on/off ramps for Freeway 110

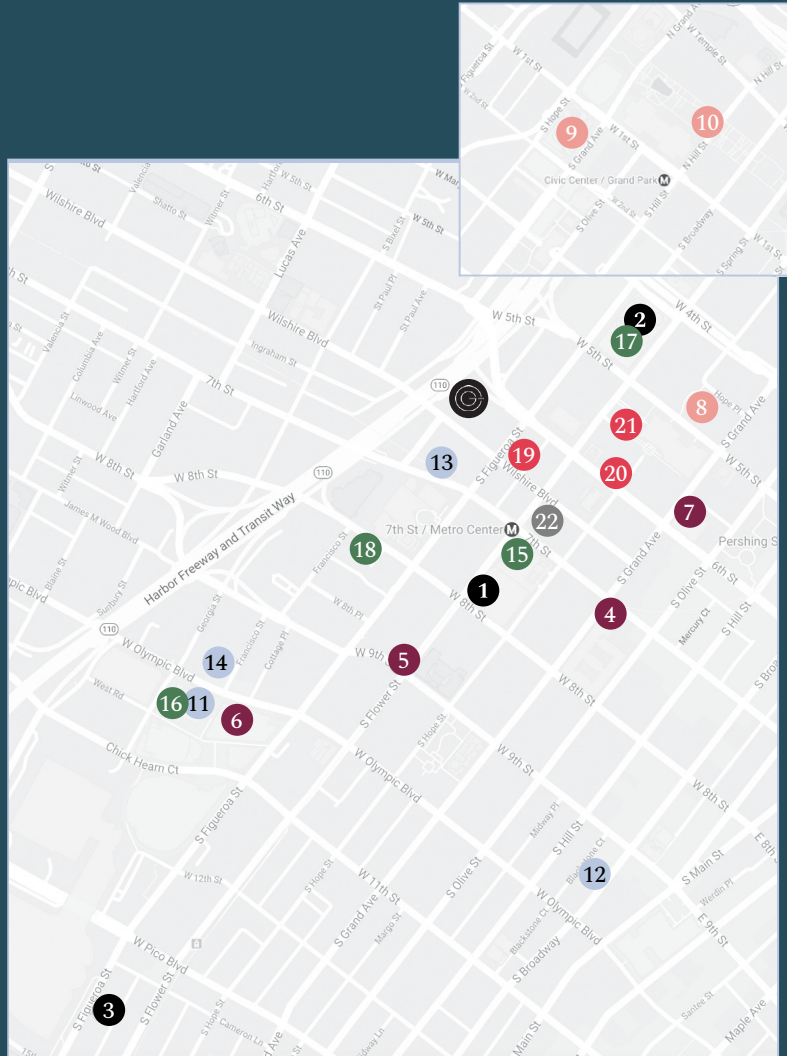

### Office Support:

- US Post Office**  
750 W 7th St Ste 201,  
Los Angeles, CA 90017  
(800) 275-8777
- FedEx Office Print & Shop Center**  
404 S Figueroa St,  
Los Angeles, CA 90017  
(213) 622-2045
- The UPS Store**  
1360 S Figueroa St Suite D,  
Los Angeles, CA  
90015(312) 600-9200



### Restaurants:

- Bottega Louie**  
*Pizzas, pastas & small plates*  
700 S Grand Ave,  
Los Angeles, CA 90017  
(213) 802-1470
- Faith & Flower**  
*American restaurant, serving rustic dishes, raw bar, and craft cocktails*  
705 W 9th St, Los Angeles, CA 90015  
(213) 239-0642
- Rosa Mexicano**  
*Modern Mexican chain eatery*  
800 W Olympic Blvd,  
Los Angeles, CA 90015  
(213) 746-0001
- Water Grill**  
*Downtown landmark presents an array of delicately prepared seafood*  
544 S Grand Ave,  
Los Angeles, CA 90071  
(213) 891-0900



### Local Attractions:

- OUE Skypace LA**  
*Open-air observation deck providing 360-degree views of the city*  
633 W 5th St #840,  
Los Angeles, CA 90071  
(213) 894-9000
- Walt Disney Concert Hall**  
111 S Grand Ave, Los Angeles, CA 90012  
(323) 850-2000
- Grand Park**  
200 N Grand Ave,  
Los Angeles, CA 90012  
(213) 972-8080



### Hotels:

- The Ritz-Carlton**  
900 W Olympic Blvd,  
Los Angeles, CA 90015  
(213) 743-8800
- Ace Hotel**  
929 S Broadway,  
Los Angeles, CA 90015  
(213) 623-3233
- InterContinental**  
900 Wilshire Blvd,  
Los Angeles, CA 90017  
(213) 688-7777
- Courtyard by Marriott**  
901 W Olympic Blvd,  
Los Angeles, CA 90015  
(213) 443-9222



### Car Rental:

- Budget Car Rental**  
700 W 7th St, Ste A200,  
Los Angeles, CA 90017  
(626) 642-9622
- Hertz**  
900 W Olympic Blvd,  
Los Angeles, CA 90015  
(213) 765-8659
- Enterprise Rent-A-Car**  
404 S Figueroa St,  
Los Angeles, CA 90071  
(213) 312-0070
- Sixt Rent A Car**  
990 W 8th St,  
Los Angeles, CA 90017  
(424) 218-3940



### Parking:

- SP+Parking**  
616 S Figueroa St,  
Los Angeles, CA 90017  
(213) 327-0499

- Paragon Parking**  
557 S Hope St,  
Los Angeles, CA 90017  
(213) 689-4818

- Maguire Gardens Parking**  
544 S Flower St,  
Los Angeles, CA 90017



### Public Transit:

- Metro Center Station**  
7th St & S Flower  
St Los Angeles, CA 90017