

2501 CAPITOL AVENUE



MID-MOD *Suites*

FULLY FURNISHED OFFICE SUITES FOR LEASE

ARIEL FOX, PARTNER BRE #01496200 | 916.473.8805 | afox@retailwestinc.com

retail*west*

Property Profile



ADDRESS:

2501 Capitol Ave,
Sacramento, CA 95816

SUITES:

8 private office suites for 1-2
people
4 dedicated desks

RENT:

\$550-\$1,200/mo per suite
\$450/mo per desk

ON SITE PARKING:

\$150/mo per stall

TRANSPORTATION:



0.4 miles to Business 80
1 mile to Highway 50



0.37 miles to Light Rail



Bike score: 100



Walk score: 92

AMENITIES:

- ✦ Discerning Capitol Avenue address
- ✦ Mid-century modern architecture
- ✦ Some suites have floor-to-ceiling windows with plenty of natural light
- ✦ Utilities and WIFI (1Gb speed) included
- ✦ Keyless entry to building and suites
- ✦ Each suite has a private locking mailbox
- ✦ Shared break room, conference room, and reception
- ✦ Walking distance to great restaurants, boutiques and entertainment



The Neighborhood

3501 CAPITOL AVENUE
MID-MOD
Suites

EXPERIENCE THE “COOL FACTOR” OF MIDTOWN
ON YOUR WALKS AND BUSINESS LUNCHES.



Floor Plan

2501 CAPITOL AVENUE
MID-MOD
Suites

FIRST FLOOR

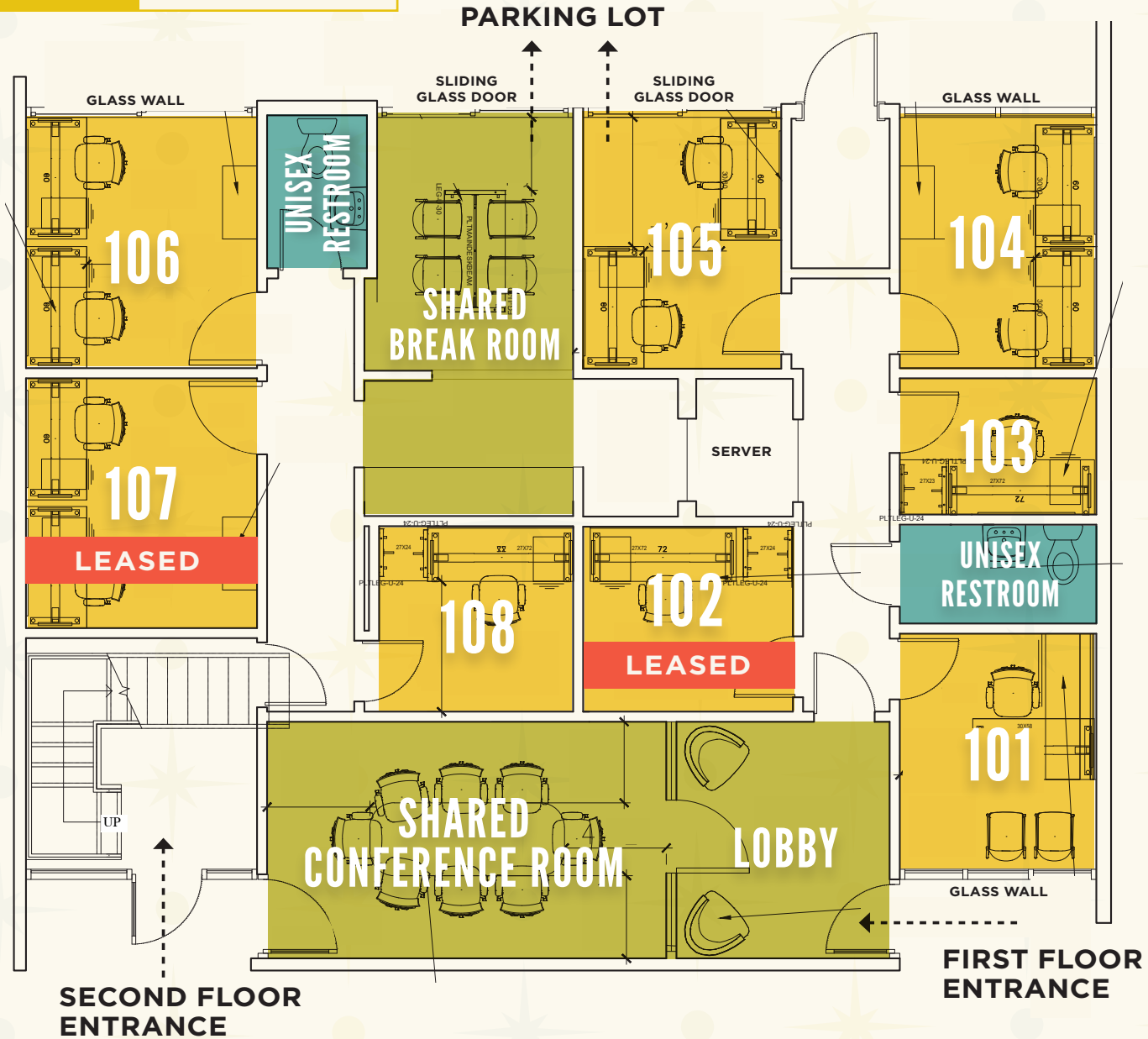



2501 CAPITOL AVENUE



MID-MOD *Suites*

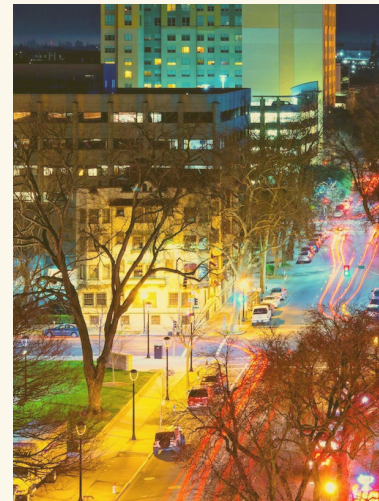

ARIEL FOX, PARTNER BRE #01496200 | 916.473.8805 | afox@retailwestinc.com

retailwest