

# Bushwick

## Located in the Heart of Brooklyn's New Creative Hub

Nestled in between the Flushing and Myrtle Avenue M, J, and Z subway stops, Bond Bushwick bridges two thriving neighborhoods. Glass atriums enclose the central terrazzo stairway leading to expansive roof decks and flood all three floors with sunlight. Exposed brick and bleached wood floors create a completely unique work environment.

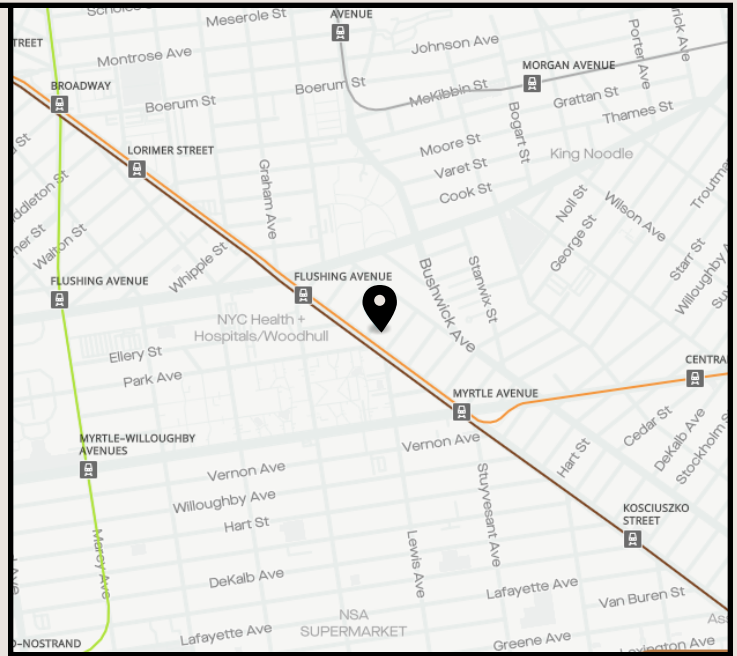

SUBWAY LINES (L) (G) (J) (M) (Z)

## Amenities

- 24 Hour Access
- IT Support
- Daily On-site Cleaning
- Showers & Towel Service
- Mother's Room
- Inside Bike Storage
- Phone Booths
- Conference Rooms
- Mail & Package Receiving
- Outside Tables
- Inside Event Space
- Outside Event Space
- Beer / Kombucha / Tea
- Espresso Machine
- Honor Bar & Spa Water
- Citi Bike Within 2 Blocks
- Public Transit Within 2 Blocks
- Fresh Fruit
- Pet Friendly



855-926-9675

BUSHWICK@BOND Collective.COM



12 PARK STREET  
BROOKLYN, NY, 11206

BOND Collective.COM

12 Park Street  
Brooklyn, NY, 11206  
**BUSHWICK@BONDCOLLECTIVE.COM**  
(855) 926-9675

**BUSHWICK@BOND Collective.COM**  
**(855) 926-9675**

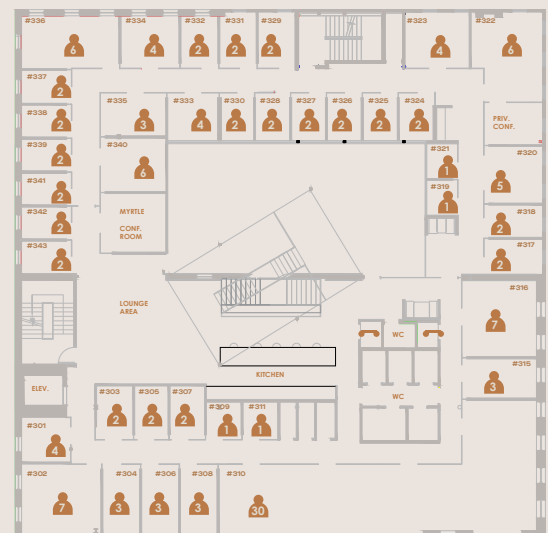
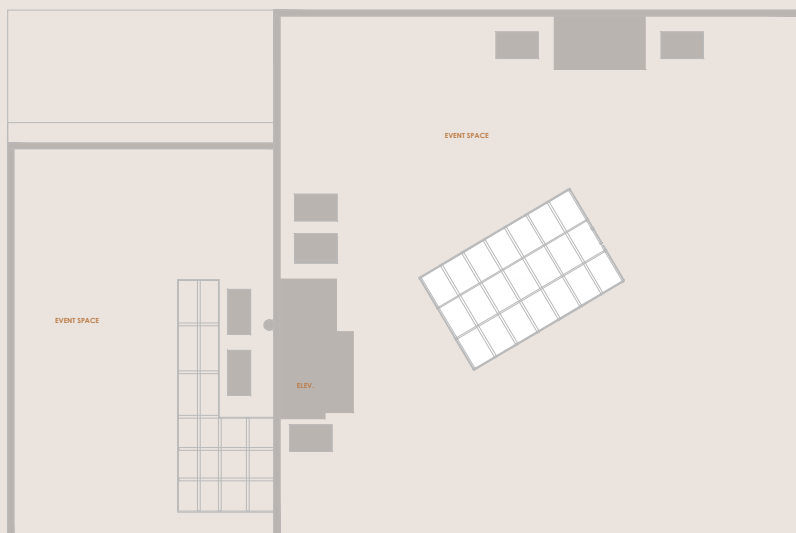



# BOND

COLLECTIVE



Thoughtfully curated  
boutique work environments  
that provide an unmatched  
experience.



855-926-9675

BUSHWICK@BONDCOLLECTIVE.COM



12 PARK STREET  
BROOKLYN, NY, 11206  
BONDCOLLECTIVE.COM