

Center City Located in the historic Suburban Station

Situated in the penthouse level of the iconic Suburban Station, our Philadelphia location is truly a destination. Steps away from the newly designed 'Love Park', it has direct access to major highways and makes commuting a breeze. Cowork from the mezzanine level which overlooks an expansive lounge perfect for entertaining. A wraparound terrace provides breathtaking views, while a quiet study ensures you'll have a place to pause between meetings.

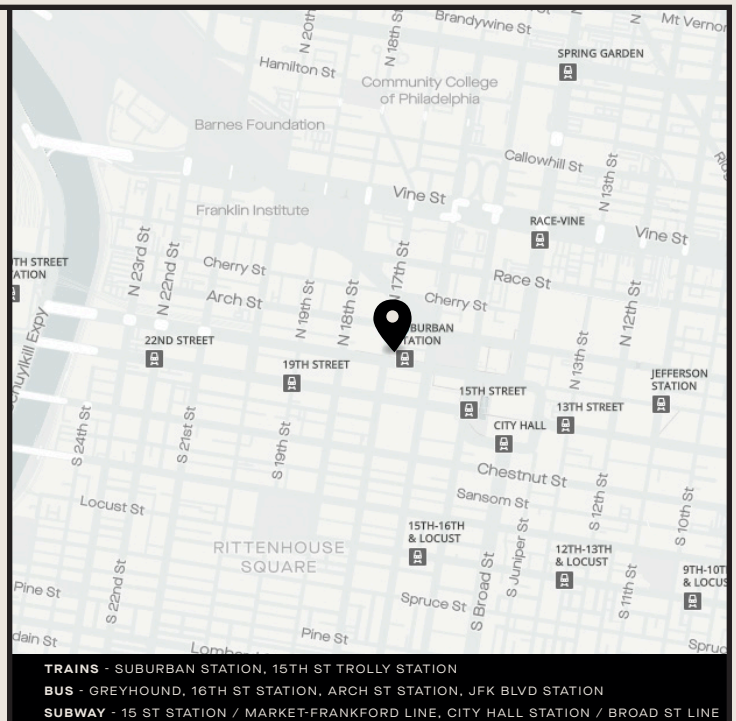

Amenities

- 24 Hour Access
- IT Support
- Daily On-site Cleaning
- Showers & Towel Service
- Mother's Room
- Inside Bike Storage
- Phone Booths
- Conference Rooms
- Mail & Package Receiving
- Outside Tables
- Inside Event Space
- Outside Event Space
- Coffee / Beer / Kombucha / Tea
- Espresso Machine
- Bond Pantry & Spa Water
- Gym Membership Discount
- Indego Bike at Street Level
- Public Transit Within 2 Blocks
- Fresh Fruit



855-926-9675

CENTERCITY@BONDCOLLECTIVE.COM



1617 JFK BOULEVARD, 20TH FLOOR
PHILADELPHIA, PA 19103

BONDCOLLECTIVE.COM

1617 JFK BOULEVARD, 20TH FLOOR
PHILADELPHIA, PA 19103

Center City Floor Plans

855-926-9675
CENTERCITY@BONDCollective.COM

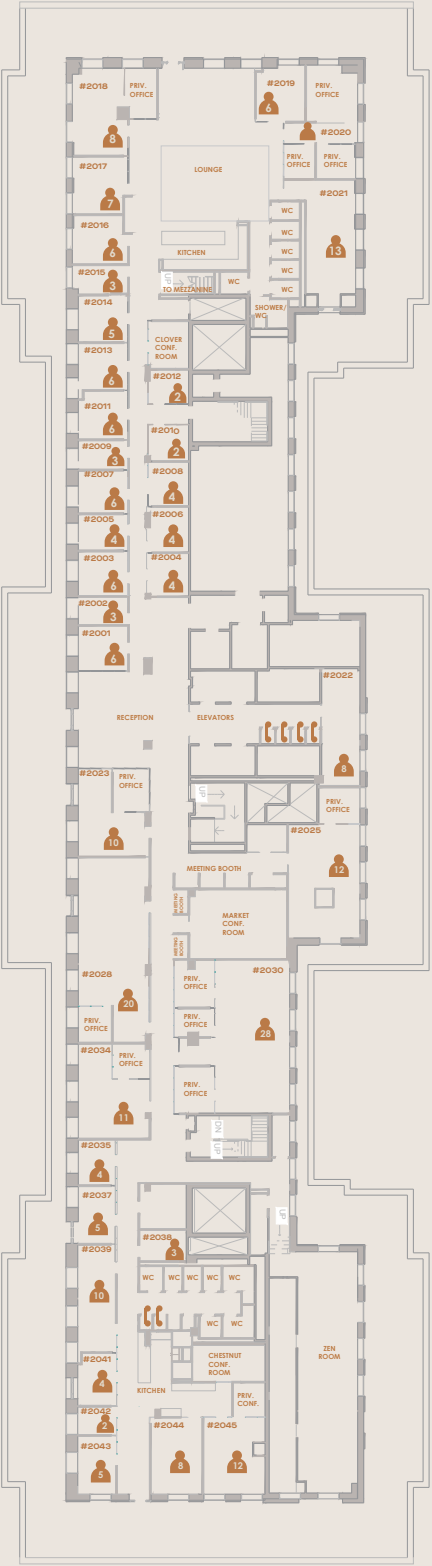

20th Floor

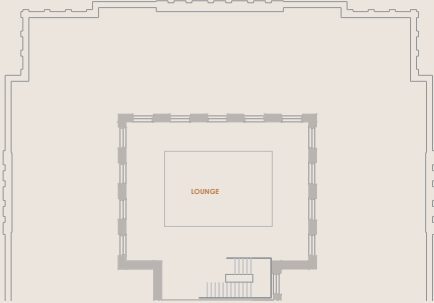

Mezzanine

BOND

COLLECTIVE



Thoughtfully curated
boutique work environments
that provide an unmatched
experience.



855-926-9675

CENTERCITY@BONDCOLLECTIVE.COM



1617 JFK BOULEVARD, 20TH FLOOR
PHILADELPHIA, PA 19103

BONDCOLLECTIVE.COM