

ONE**VALLEY**

Pittsburgh, PA

4170 Second Avenue

Turn Key Offices &
Coworking Space

COVID safe space
with decreased
operating capacity

**100 - 500
SF AVAILABLE**

OneValley Innovation Center

pghcommunity@theonevalley.com



ONEVALLEY

Located off of Blair St. in Hazelwood Green, you'll find our captivating creative work space that offers flexibility and an amenity rich experience built for any size company, whether you're a founder with a billion dollar idea or an enterprise company looking to host your team in the heart of Pittsburgh's up and coming innovation district!

Our specialty is curating a community of entrepreneurs dedicated toward innovating for our future. Uniquely, we are not only a co-working space, we support and foster the global entrepreneurship ecosystem through our innovation centers and through the Pittsburgh Entrepreneurship Platform built on Passport, our global founder community and online portal for startup resources.



Included with every membership

Supporting startups where and when it matters most. PEP offers startups a city-wide resource network of mentors, investors, and learning content. PEP also offers Pittsburgh startups access to Passport, the world's most comprehensive digital innovation platform. Save on essential tools and services valued at over \$1M, across cloud computing, video conferencing, payments, CRM, sales tools, and much more. Connect with tens of thousands of like-minded founders supporting one another through shared experiences, advice, and networking.

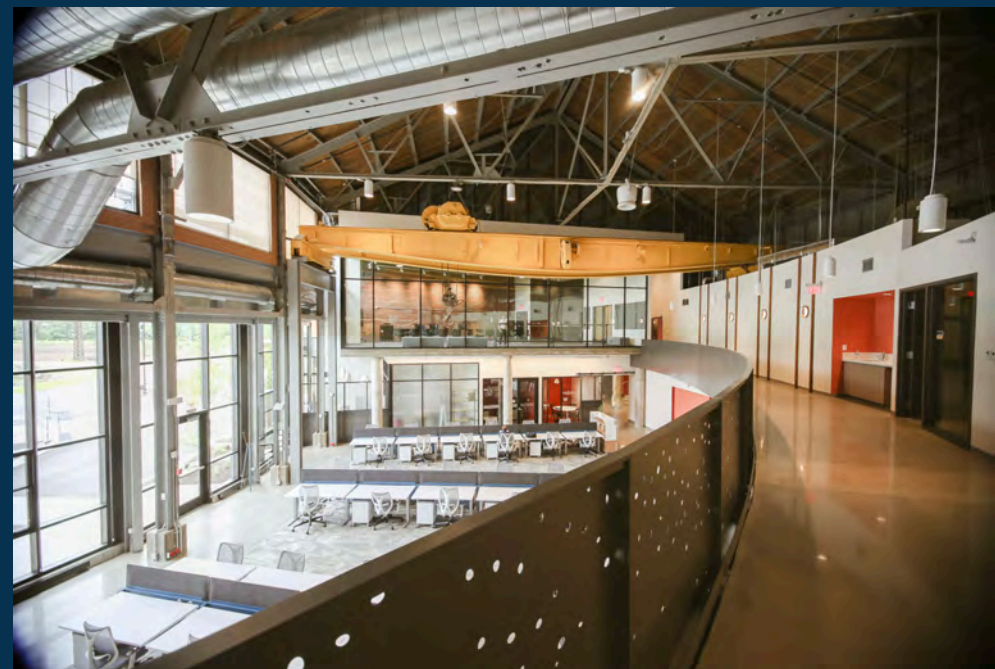

ONEVALLEY

- **Robust COVID protocols in place to ensure safety and sanitation**
- Health survey and temperature check in upon entry
- 12 sanitation stations located in building
- Masks required in common areas
- Operating at 50% max capacity to allow for safe, social distancing
- Lower occupancy in common areas and conference rooms
- Access to Passport by OneValley, a perks program valued at over \$1M in savings + access to top advisors and investors
- Ample parking access
- Fast & secure WiFi
- Private offices, dedicated desks, & hot desks available
- Standing desks and upscale furniture to choose from
- 24/7 access to workspace
- Modern kitchen & cafe lounge
- Complimentary flavored sparkling & filtered water
- Complimentary Coffee & Tea Service
- Organic, gourmet meals via Byte vending machine
- Unlimited color printing & scans
- Professional shredding service
- Outdoor Patio Area

Amenities

- 7 conference rooms available to book
- Booking credits available per membership type
- Screen casting available via monitors & projectors
- Poly-Com phones in all conference rooms

